

# Quilt Babe

58" x 74" Throw Size



## MATERIALS:

[13] AMNSH Collectible Quilt Blocks

[1] AMNSH State Block

1/2 yard Birds

1 yard Green 1

1-1/4 yard Green 2

1-7/8 yard Camping Toss

5/8 yard Bicycles

3/4 yard Minnesota Words, Blue

3/8 yard Flowers

1/2 yard Minnesota Words, Red

2/3 yard of your fabric choice for binding

***THIS IS CONSIDERED AN INTERMEDIATE SKILL LEVEL QUILT. READ THROUGH ALL INSTRUCTIONS BEFORE BEGINNING. SEW PIECES RIGHT SIDES TOGETHER (RST) AND USE A 1/4" SEAM ALLOWANCE THROUGHOUT. FOR THIS PATTERN, WE WILL CUT STRIPS BY THE WOF (WIDTH OF FABRIC) UNLESS OTHERWISE NOTED. HST = HALF SQUARE TRIANGLES***

## CUTTING INSTRUCTIONS:

### From Birds Fabric:

Cut [1] - 8-7/8" × WOF strip  
Subcut [2] - 8-7/8" squares  
Cut [1] - 4-1/2" × WOF strip  
Subcut [7] - 4-1/2" squares  
Subcut [4] - 2-1/2" squares  
Cut [1] - 2-1/2" × WOF strip  
Subcut [17] - 2-1/2" squares

### From Green 1 Fabric:

Cut [1] - 8-7/8" × WOF strip  
Subcut [4] - 8-7/8" squares  
Cut [1] - 4-1/2" × WOF strip  
Subcut [2] - 4-1/2" squares  
Subcut [1] - 2-1/2" × 4-1/2" rectangle  
Cut [4] - 2-1/2" × WOF strip  
Subcut [59] - 2-1/2" squares  
Cut [3] - 2-7/8" × WOF strip  
Subcut [34] - 2-7/8" squares

### From Green 2 Fabric:

Cut [1] - 8-7/8" × WOF strip  
Subcut [4] - 8-7/8" squares  
Cut [1] - 4-1/2" × WOF strip  
Subcut [3] - 4-1/2" squares  
Subcut [9] - 2-1/2" × 4-1/2" rectangle  
Cut [3] - 2-1/2" × WOF strips  
Subcut [40] - 2-1/2" squares  
Cut [2] - 2-7/8" × WOF strips  
Subcut [18] - 2-7/8" squares

### From Bicycles Fabric:

Cut [2] - 2-1/2" × WOF strip  
Subcut [26] - 2-1/2" squares  
Cut [2] - 2-7/8" × WOF strip  
Subcut [17] - 2-7/8" squares  
Cut [1] - 8-1/2" × WOF strip  
Subcut [1] - 8-1/2" square

### From Camping Toss Fabric:

Cut [4] 4" × LOF - CUT THIS FIRST FROM REMAINING FABRIC (26" WIDE):  
Cut [2] - 8-7/8" × WOF strip  
Subcut [3] - 8-7/8" squares  
Cut [3] - 2-1/2" × WOF strip  
Subcut [22] - 2-1/2" squares  
Cut [2] - 2-7/8" × WOF strip  
Subcut [14] - 2-7/8" squares

### From Minnesota Words, Blue Fabric:

Cut [1] - 8-7/8" × WOF strip  
Subcut [2] - 8-7/8" squares  
Cut [2] - 2-1/2" × WOF strip  
Subcut [31] - 2-1/2" squares  
Cut [1] - 2-7/8" × WOF strip  
Subcut [13] - 2-7/8" squares

### From Flowers Fabric:

Cut [1] - 4-1/2" × WOF strip  
Subcut [5] - 4-1/2" squares  
Cut [1] - 2-7/8" × WOF strip  
Subcut [7] - 2-7/8" squares  
Cut [2] - 2-1/2" × WOF strip  
Subcut [18] - 2-1/2" squares

### From Minnesota Words, Red Fabric:

Cut [7] - 2" × WOF, for inner border

## BLOCK ASSEMBLY:

All blocks are 8-1/2" unfinished/8" finished. Most block pieces are very basic: squares in [3] sizes: 8-1/2", 4-1/2", 2-1/2". HST in [2] sizes (8-1/2" & 2-1/2"). All seams are 1/4".

### HST Instructions:

There are [2] sizes of HST in this quilt. 8-1/2", made with 8-7/8" squares of 2 different fabrics, and 2-1/2", made with 2-7/8" squares of [2] different fabrics. The process is the same.

1. Lay [2] different squares RST and draw a diagonal line from corner to corner on one square.
2. Sew a scant 1/4" seam on each side of the line. Carefully cut on the line and press open. Square up to 8-1/2" or 2-1/2".

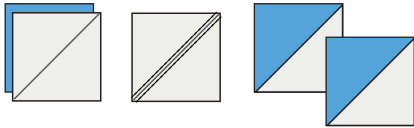

3. Consult the color block chart to see where the different colors go. Sew smaller pieces together first, then sew in rows. Many of the blocks are unique and appear only once.

### Block 1:

Block one is a basic 4-patch pattern used for blocks 1, 3 and 5.

1. The top [2] 4-1/2" squares are sewn together with the finished seam pressed left. Repeat for lower [2] squares, pressing seam to the right. With RST, nest center seams. Sew. Press.

'Nesting' snugs your seams together giving you crisp, neat blocks. Refer to individual block layouts and pdfs for color placement and cutting. Make [3] blocks total.

2. Blocks 1 & 5 are Birds fabric with AMNSH Collectible Quilt Blocks mixed in.
3. Block 3 is the Green 1 and Green 2 fabrics used for blocks 2, 4, 8, 14, 15, 20, 21, 31, 38, 40, 42, 44, 46, & 47.

### Block 2:

This is a 2-color block with 8-7/8" HSTs. Looking at color placement and cutting chart, make [14] blocks total.

1. For each HST, cut a square 8-7/8" of each color needed and cut on the diagonal carefully.
2. Sew the [2] colors together along their long edge. [7] will be Green 1 and Green 2; [3] will be 2 shades of blue, [2] will be Camping Toss & Green; [1] will be Blue & Green; and [1] will be Birds & Blue.
3. Trim to 8-1/2".

**Note:** For multiples of the same 2 colors, it is easier to put the 2 square RST, draw a diagonal line, sew 1/4" on each side of line and cut on line.

4. Press well. Label blocks for easier placement later.

### Block 6:

Block 6 has 9 patches. It's a variation of Block 1. Referring to block layout, cut pieces from desired colors and lay out on mat in order before sewing.

1. Starting on left edge, sew HSTs together first to create squares.
2. Join these to [2] squares below to make a 1/4" block. Press.
3. Continue sewing block in same order used for Block 1. Press.

### Blocks 7, 9, 10, 11, 12, 13, 16, 17, 18, 19, 23, 24, 26, 27, 28, 29, 34, 35, 36

These [20] blocks are all variations of patterns 1 and 2. Using the same techniques, refer to charts for color placement and cutting, noting where store squares are inserted.

1. I find that sewing from smallest to largest piece and joining rows together keeps my blocks square.
2. Label blocks with numbers upon completion. Press well.

**Note:** Block 23 is marked for eye placement. This may be applique, embroidery or simply quilted into your final top and can wait until all top piecing is finished.

### Blocks 25, 30 and 39 (see diagram):

These are your [3] yellow flower blocks. Refer to block charts for color placement and cutting.

1. Make [4] HST using [2] 2-7/8" floral and [2] Green 1 squares.

2. Make [4] HST using [2] 2-7/8" squares of Green 1 & Green 2.
3. Sew [2] pairs tighter to form point with Green 2 & Floral.

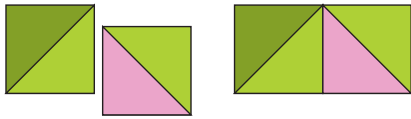

4. Stitch to right and left side of 4-1/2" Flower square as shown.
5. Lay out in rows with 2-1/2" square of Green 1 in corners. Sew together in rows.
6. All remaining squares and HST are Green 1. Make [3] EXCEPT for [1] block (Block 30) has a HST in the lower left corner that is Minnesota Words, Blue/Green 1.

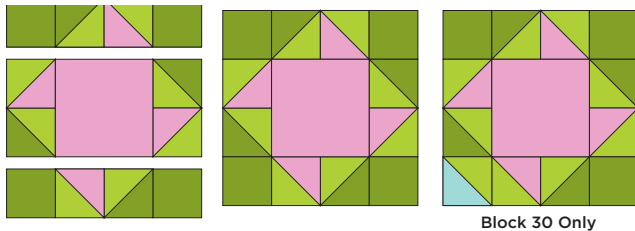

### Block 22:

Block 22 is a Bicycles Fabric 8-1/2" blue square.

### Blocks 32 and 45:

These are a common quilt block, with many pieces.

1. Referring to block charts, cut and sew, pressing carefully. Keeping seams at 1/4" is VERY important to maintain integrity of block. Label for later placement.
2. Prepare [16] HST blocks using the 2-7/8" squares of Green 1 and Green 2 fabrics.
3. Lay out in rows of 4 HST, sew rows together.

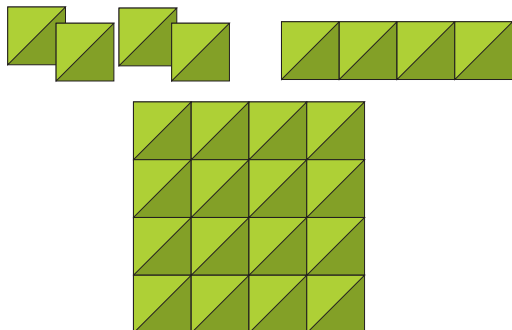

### Blocks 37 and 41:

These are yellow star blocks easily assembled with HST and squares. Using chart, note color placement and cutting order.

You need [4] flying geese that measure 2-1/2" x 4-1/2". Use your preferred method or construct as follows:

4. Lay a Floral 2-1/2" square on one side of the green 2-1/2" x 4-1/2" rectangle. Draw a diagonal line as shown.
5. Sew on the line, trim the corner seam to 1/4" and press the Floral away from Green. In the same manner, place another Floral 2-1/2" square on the other side and repeat. Trim, flip up and press. Make [8] for [2] stars.

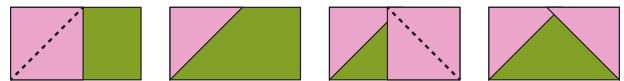

6. Sew unit to the right and left side of the 4-1/2" floral square, making sure the floral points are going toward the outside of the block. Press seams toward the 4-1/2" square.
7. Make 2 rows with a goose in the middle and 2-1/2" Green squares on both ends, press toward Green squares. Sew the [3] rows together, nesting the seams. Make [2].

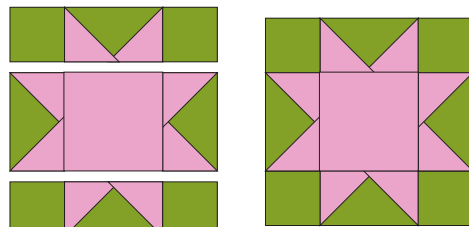

### Block 43:

Using [1] 2-1/2" x 4-1/2" Green 1 rectangle, [1] 2-1/2" x 4-1/2" Green 2 rectangle, [2] 2-1/2" Green 2 squares, [6] 2-1/2" Green 2 squares and [1] AMNSH Collectible Quilt Block create the Block 43 as shown.

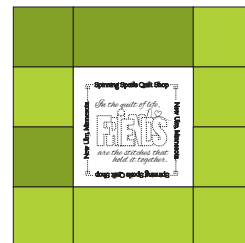

### Block 48:

Block 48 is your 8-1/2" preprinted state block.

## QUILT TOP ASSEMBLY:

1. Using Babe diagram on the next page, lay out all sewn block in rows for placement. This is where your labelling is a real time-saver.
2. Sew blocks into rows, pressing seams opposite directions each row so rows will nest together neatly during final assembly.
3. Join rows. Press.

## BORDERS:

1. Sew the [7] 2" × WOF Minnesota Words, Red fabric together end to end.

2. Measure quilt, cut [2] the length of sides and sew to right and left sides.
3. Measure width, cut [2] the width of quilt and sew to top and bottom.
4. Repeat with 4" × WOF Camping Toss borders, sewing sides on first, then top and bottom.

## FINISHING:

1. Back, quilt and bind your quilt using your favorite methods. See yardage chart for fabric requirements. Binding is figured at 2-1/4".
2. Enjoy!



## *Kandace Kelderman*

World's okayest grandma who loves quilting and teaching at quilt retreats. When she isn't near the water, she is a Donate Life ambassador, reader, sarcastic wife and mom. Find her at Kandace Kelderman on FB or [kandacekeld@yahoo.com](mailto:kandacekeld@yahoo.com).

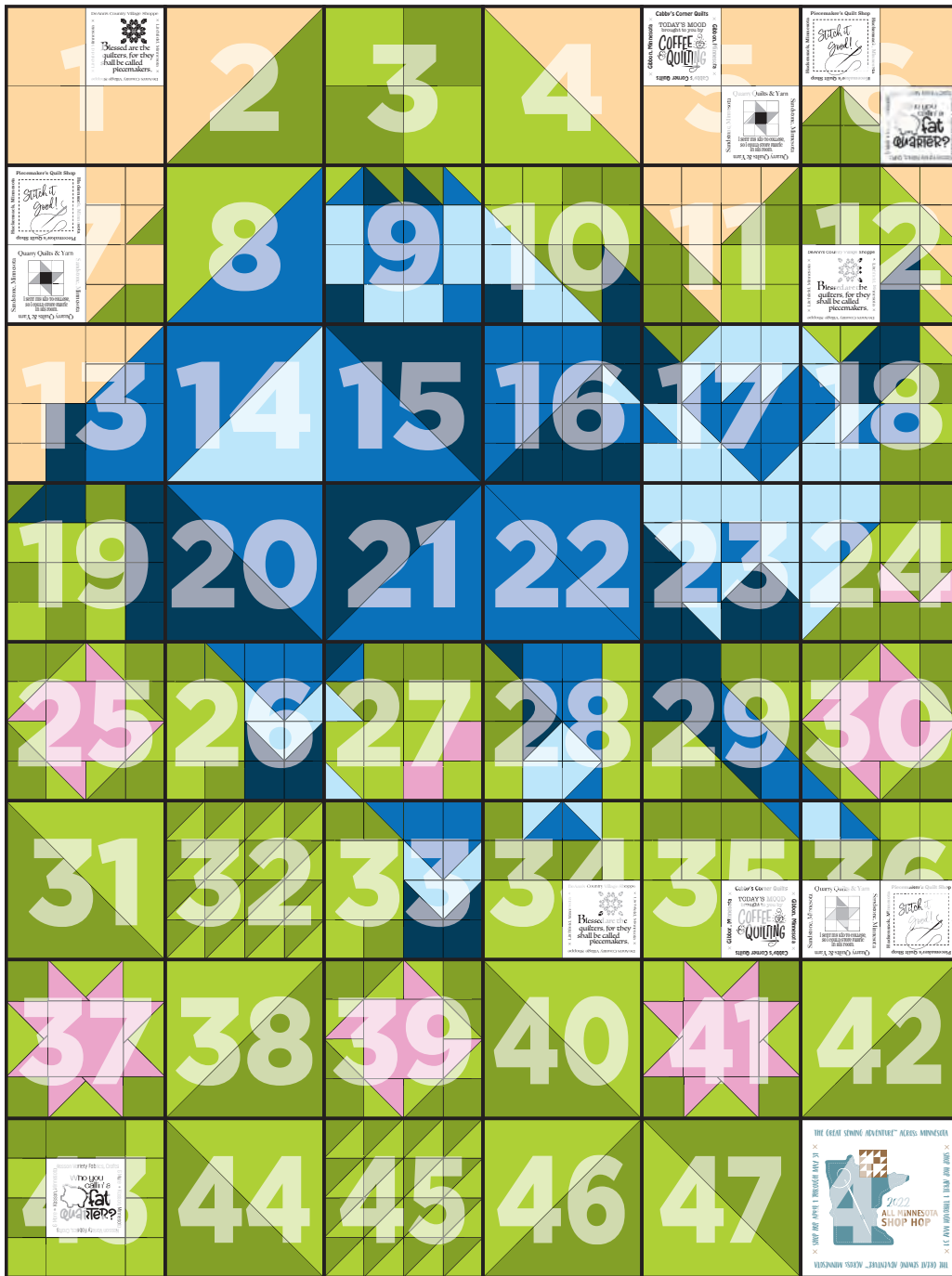

- Birds
- Green 1
- Green 2
- Bicycles
- Minnesota Words, Blue
- Camping Toss
- Flowers

